



# TRENT VALLEY WOODTURNERS



LOTTERY FUNDED

# WOODWORD



Demonstrations	Competitions
Brian Cockerill	Door Stops
Rick Dobney	

Spring 2019  
Issue 98

## CONTENTS

### PAGE No

2	Editor's Comments
2	AGM Report
3-5	Dates for your diary 2019
6	Club Nights & Demonstrations 2019
6	Forthcoming Events
8	Chestnut Products Woodturning Weekender
9-10	January 2019 Demonstration - Brian Cockerill
11	Competition Results - January - Pair of Door Stops
13	Classified Ads
14-15	February 2019 Demonstration - Rick Dobney
17	Newark Show 2018
19	Trent Valley Trading
19	TVWT Club Website and Facebook Information
20	Rogues Gallery (Your 2018/2019 Committee)

### SPONSORS

7	<u>Turners Retreat</u>
12	<u>The Tool Post</u>
16	<u>Proops Brothers</u>
18	<u>Chestnut Products</u>
19	<u>Charnwood</u>

## A MESSAGE FROM THE EDITOR

Thanks to everyone at the AGM for re-electing me to the committee so that I can continue to edit this fine publication.

A special thanks to Barbara and Lynne for responding to my repeated plea for contributions from the members. Barbara gave me the AGM report and Lynne did the report and pictures from the Newark Show.



Happy Turning

**Bill**

## AGM

On Wednesday 13th March the Club held its 25th AGM. A good turnout of members made the occasion productive and constructive. Chairman Tony gave a comprehensive report for 2018, ending by thanking the membership for all they had done to support the club throughout the year. The membership also heard reports from the Secretary, Treasurer, Events Secretary, "Woodward" Magazine Editor and Webmaster.

The new Committee for 2019 was elected:

Honorary President - Vic Taft

Chair - Tony Stubbins

Vice Chair - Ian Ethell

Secretary - Barbara Rundle

Treasurer - David Routledge

Events Secretary - Derek Henderson

Committee members - Brian Deakin (new appointment), Colin Oakhill, Bill Percival, Ben Wild, and Nick Winfield (new appointment)



# TRENT VALLEY WOODTURNERS



## Dates for your Diary 2019

HO - Hands on DAY- 9.30 to 3.30. HO - Hands on EVENING - 6-9pm,

OH - Open House, no turning - 1.30 -4.30,

L2T -Learn to Turn - Trainers & Trainees only - 7-9pm.

	January	February	March	April
Mon				1
Tues	1			2 HO
Wed	2			3
Thurs	3			4 HO
Fri	4	1 L2T	1 L2T	5
Sat	5	2	2	6
Sun	6	3	3	7
Mon	7	4	4	8
Tues	8	5 HO L2T	5 HO L2T	9
Wed	9 Meeting	6 L2T	6 L2T	10 Meeting
Thurs	10	7 HO	7 HO	11
Fri	11	8 L2T	8 L2T	12
Sat	12 HO	9	9	13 HO
Sun	13	10	10	14
Mon	14	11	11	15
Tues	15	12	12	16
Wed	16 OH	13 Meeting	13 Meeting AGM	17 OH
Thurs	17 HO	14	14	18 HO
Fri	18 L2T	15 L2T	15	19 EASTER
Sat	19	16 HO	16 HO	20 EASTER
Sun	20	17	17	21 EASTER
Mon	21	18	18	22 EASTER
Tues	22 L2T	19 L2T	19 L2T	23
Wed	23 L2T	20 OH L2T	20 OH L2T	24
Thurs	24	21 HO	21 HO	25 HO
Fri	25 L2T	22 L2T	22 Newark Show	26
Sat	26	23	23 Newark Show	27
Sun	27	24	24	28
Mon	28	25	25	29
Tues	29 L2T	26 L2T	26 L2T	30
Wed	30 L2T	27 L2T	27 L2T	
Thurs	31 HO	28 HO	28 HO	
Fri			29	
Sat			30	
Sun			31	
Mon				

	May	June	July	August
Mon			1	
Tues			2 HO	
Wed	1		3	
Thurs	2 HO		4 HO	1 HO
Fri	3		5	2
Sat	4	1	6	3
Sun	5	2	7	4
Mon	6 BANK HOLIDAY	3	8	5
Tues	7	4 HO	9	6 HO
Wed	8 Meeting	5	10 Meeting	7
Thurs	9	6 HO	11	8
Fri	10	7	12	9
Sat	11 HO	8	13 HO	10
Sun	12	9	14	11
Mon	13	10	15	12
Tues	14	11	16	13
Wed	15 OH	12 Meeting	17 OH	14 Meeting
Thurs	16 HO	13	18 HO	15 HO
Fri	17	14	19	16
Sat	18	15 HO	20	17 HO
Sun	19	16	21	18
Mon	20	17	22	19
Tues	21	18	23	20
Wed	22	19 OH	24	21 OH
Thurs	23	20 HO	25 HO	22
Fri	24	21	26	23
Sat	25	22	27	24
Sun	26	23	28	25
Mon	27 BANK HOLIDAY	24	29	26 Beacon Hill event
Tues	28	25	30	27
Wed	29	26	31	28
Thurs	30 HO	27 HO		29 HO
Fri	31	28		30
Sat		29		31
Sun		30		
Mon				
Tues				

	September	October	November	December
Sun				1
Mon				2
Tues		1 HO		3 HO
Wed		2		4
Thurs		3 HO		5 HO
Fri		4	1	6
Sat		5	2	7
Sun	1 Sutton Bonington Show	6	3	8
Mon	2	7	4	9
Tues	3 HO	8	5 HO	10
Wed	4	9 Meeting	6	11 Meeting - Social
Thurs	5 HO	10	7 HO	12
Fri	6	11	8	13
Sat	7	12 HO	9	14 HO
Sun	8	13	10	15
Mon	9	14	11	16
Tues	10	15	12	17
Wed	11 Meeting	16 OH	13 Meeting	18
Thurs	12	17 HO	14	19
Fri	13	18	15	20
Sat	14 HO	19	16 HO	21
Sun	15	20	17	22
Mon	16	21	18	23
Tues	17	22	19	24
Wed	18 OH	23	20 OH	25 XMAS DAY
Thurs	19 HO	24	21 HO	26 BOXING DAY
Fri	20	25	22	27
Sat	21 Elvaston Castle	26	23	28
Sun	22 Elvaston Castle	27	24	29
Mon	23	28	25	30
Tues	24	29	26	31
Wed	25	30	27	
Thurs	26 HO	31 HO	28 HO	
Fri	27		29	
Sat	28		30	
Sun	29			
Mon	30			

## Club Nights 2019

DATE	DEMONSTRATOR
Jan 9th	Brian Cockerill
Feb 13th	Rick Dobney
March 13th	AGM
April 10th	Steve Heeley
May 8th	Peter Hallam
June 12th	Emma Cook
July 10th	Robert Till
August 14th	Joey Richardson
September 11th	Jonathan Hart
October 9th	Gerry Marlow
November 13th	Richard Findley
December 11th	Xmas social

### FORTHCOMING LOCAL EVENTS

26 August - Beacon Hill

1 September - Sutton Bonington

21-22 September - Elvaston Castle

### DEMONSTRATIONS FURTHER AFIELD

3-4 August - Chestnut Products Woodturning Weekender - see **p8** for details

**Turners Retreat**

THE WOODWORKERS SOURCE

**Craft Supplies**

BE INSPIRED, BE CREATIVE

**Nick Agar**  
**SIGNATURE**  
**SERIES**



Now available  
at  
**Turners  
Retreat**



## PETER CHILD ARTIST'S PYROGRAPHY MACHINE

*Create beautiful textures,  
designs and patterns.*

- Slim, light and comfortable pen design
- Perfect for precise detailed work
- Cool running handle for comfort
- Warms from cold in 2 seconds
- Excellent reliability
- Incredible durability

*'I use it every day, its durability is  
nothing short of amazing – it's  
perfect for me and my students.'*

**Bob Neill**

Professional pyrographer and teacher

**Craft Supplies**

A product by... BE INSPIRED, BE CREATIVE

Turners Retreat, Faraday Close, Harworth DN11 8RU

[www.turners-retreat.co.uk](http://www.turners-retreat.co.uk)

01302 744344

[eshop@turners-retreat.co.uk](mailto:eshop@turners-retreat.co.uk)



# Chestnut Products Woodturning Weekender

A message from Terry Smart of Chestnut Products

Well known finishing suppliers and magazine sponsors Chestnut Products are 25 years old! To celebrate they are throwing a party thinly disguised as a woodturning event. Called the Woodturning Weekender it boasts four top name demonstrators from the world of turning showing their skills and offering inspiration over two days, 3rd and 4th August 2019.



The Saturday starts off with Stewart Furini, known to many for his YouTube channel showing different decorative ideas and techniques backed up with a solid knowledge of 'real' turning - something often missing on some YouTube channels. In the afternoon the stage is taken over by Phil Irons who needs virtually no introduction.

On Sunday Gary Lowe RPT starts proceedings and is followed in the afternoon by Emma Cook (aka the Tiny Turner); both of them have a natural ability to convey their thoughts and demonstrate and will be producing some thought-provoking work.

During breaks, when the main stage isn't in use, there will be other demonstrations and displays going on around the hall and of course a chance to chat with the other turners there.

And it wouldn't be a birthday celebration without some sort of party, and that's on Saturday evening. There's no loud music and definitely no dance floor; instead there's a professionally catered barbecue, a pleasant social evening to mix with old friends and make some new ones too. All the demonstrators will be in attendance to chat to, plus staff from Chestnut Products (all three of them!). They also promise a few surprises during the evening and a grand finale at around 9pm, so don't sneak away early.

The event is being held at the Springfields Event Centre in Spalding, Lincolnshire, at tickets start at £20.

For more information visit [www.woodturningweekender.co.uk](http://www.woodturningweekender.co.uk) or call Chestnut on 01473 890118.

## Brian Cockerill Demonstration Evening 9-January-2019

Brian lives in Oadby, Leicester and has been turning professionally for about 7 years, specialising in making tools and handles, often to renovate old and often abandoned tools. He very kindly made available a printed page describing his demonstration which saved me a great deal of note taking !



For this evening's demonstration Brian made a handle for a brand new 3/8" spindle gouge. The equipment needed for the project was listed as :-

- Wood blank (2" \* 2" \* 14")
- Scrolling 4 jaw chuck with jaws to suit the size of tenon required
- Spindle roughing gouge
- Spindle gouge and/or skew chisel
- Ferrule – either a length of copper pipe or a straight copper connector sawn in half.
- Drill chuck and drill bit (13mm for this example)
- Sanding sheets (120-240 grit)
- Finish (Shellac sealer & Friction polish)

The way the handle is produced is the same for most types and sizes of handles, all that changes are the overall dimensions.

- Mark both ends of the blank for centres. Brian prefers to use a scribe rather than a pencil as it gives a finer line (and doesn't need sharpening all the time !).
- Mount the blank between centres (always turn between centres rather than in a chuck if possible; it gives far more accurate results and much better feedback) rough out to a cylinder.
- Cut a tenon to suit the jaws of your chuck. Then remount the blank in the chuck.
- True up the end grain then sand and finish the end at this stage.
- Mount the drill chuck in the tail stock and drill out the hole to accept the tool tang. Brian starts the drilling using a machinist's centring bit to ensure the hole starts accurately. If the tool tang is tapered, then drill the full depth using a narrow bit (eg. 8mm) then drill to half the depth using a broader bit (eg. 10mm) and finally to quarter depth using the final bit size (eg. 13mm). Always drill at a slow speed (400-500 rpm) and withdraw the drill frequently to clear out the shavings.
- Remount the cylinder between centres, supporting the hole end with a live cone centre.

- Mark the length of your ferrule and turn off the excess wood to ensure a snug fit for the ferrule. When this has been achieved remount the cylinder with the ferrule in place to help reduce the risk of the end of the piece splitting. Brian recommends having two ferrules, one pretty one for the finished handle, and one sacrificial one for this part of the process that won't matter if it gets marked during the turning.
- Shape your handle as desired, checking the size and shape mostly with your hand as this is where it is going to sit when finished. Starting with the transition from ferrule to handle create a palm swell and then working your way to the butt of the handle creating a taper that swells out again (essentially a large flat cove).



- Work the end of the handle down to the final shape leaving a small nub at the end (c.3mm minimum).
- Sand the handle to the desired grit (240 is fine enough), apply sealer and finish. Brian recommends applying multiple layers of both the sealer and the shellac based friction polish leaving a few seconds between each application to allow them to 'spirit off'.
- Cut off the nub with a small saw and tidy it up with a knife or chisel. Then sand and finish exactly as done for the rest of the handle to ensure it blends in correctly.
- To give the finish a longer life, you can give the handle a final buffing with caruba wax applied with a mop.
- Glue the ferrule in place and glue the inside of the tang hole (Brian uses 5 minute epoxy), insert the tool into the hole, twist to achieve the preferred grain alignment, press home and clean up any glue squeeze.
- Job done 😊



**January 2019 - COMPETITION  
RESULT  
Pair of Door Stops**



We had 4 entries and the winners were

- 1st Jim Hadfield
- 2nd Tony Haggis
- 3rd Melvin Francks



*Starting ....*



*to name but some few of our many suppliers*

*... or finishing*



*Serving and supporting Trent Valley Woodturners*

# The ToolPost

Unit 7 Hawksworth, Southmead Industrial Park, Didcot, Oxon. OX11 7HR  
01235 511101 • [www.toolpost.co.uk](http://www.toolpost.co.uk) • tour: <http://goo.gl/maps/PsjFa>

*sharing expertise*

## **CLASSIFIED ADS**

### **For Sale**

#### **Corian Blanks**

Suitable for pen blanks and light pull cords

15mm\*15mm\*150mm - 4 for £1

25mm\*25mm\*150mm - 3 for £1

Larger pieces also available

Bernard 079221 25951

I have a limited quantity of exotic hardwood pen blanks, approx 25x25x150mm.

Price on application.

Myrtle, Olivewood, Tambuti, Bubinga, Amazaque, Leadwood, Hornbeam, Tanga,  
Pau Amerello, Ropalo Lacewood, Imbuia, Moabi, Padua.

Bernard 079221 25951

### **Items Wanted**

'Tools for Africa' - if you have any surplus usable tools, please contact

Martin Gladders, Age UK - Men in Sheds, Oaks Industrial Estate, Loughborough LE11 5XN.

Tel: 01509 211603

**If any Companies are interested in placing advertisements in this  
magazine then they should contact the Treasurer.**

**Contact details are shown on the Club Website.**

**[trentvalleywoodturners.co.uk](http://trentvalleywoodturners.co.uk)**

## Rick Dobney Demonstration Evening 13-February-2019



Rick reminded us that this was his second visit to our club – his first was some years ago when he attended to be tested for and earn his tutor's badge !

His first demonstration for us tonight was a natural edge bowl. He explained that the profile of the final bowl was very dependant on the piece of wood being used, so making full use of a full branch would result in a flattish shallow



bowl (the one at the back of the picture), whereas a halved (down the pith line) branch would result in a much deeper bowl (the one at the front).

The side of the branch to become the top of the bowl was part drilled with a Forstner bit to accommodate a 4 prong drive. This way of holding the log allowed the final positioning to be manipulated to ensure that the shape of the bowl would be nicely balanced. The other side of the log was held with a live ring centre in the tail stock and turning began at a low speed as the wood initially was out of balance.

A very important feature of this type of bowl is the bark that remains on the live edge, so to minimise the chances of stripping off the bark, the cutting would be from the bark towards the base of the bowl against the grain. The initial cuts with a bowl gouge trued up the ends of the log and defined the high points of the bowl edge. The outside of the bowl was then turned down to solid wood for the creation of a chucking point and foot before blending the outside profile between the high point of the rim and the edge of the foot.

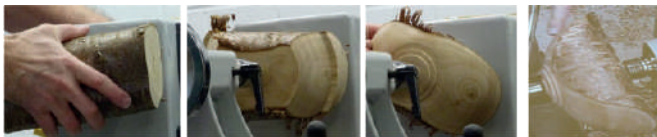

The log was then reversed onto the chucking point and the hollowing of the bowl begun, starting with gentle cuts in the centre area, working towards the centre of the bowl. Once some space had been created the cuts were progressively moved outwards until the desired rim thickness was achieved. This process was then repeated over and over, making some space in the middle and then working down the edge of the bowl keeping the edge thickness constant by presenting the bevel of the bowl gouge in line with the outside profile of the bowl. A finishing cut is made on each repetition of the process as the wings of the bowl will become too flexible to allow a decent finishing cut if this process is left until the inside of the bowl is completed. Once the wings were OK, the remaining excess wood was removed from the centre of the bowl, sanded and finished.



The final stage is the removal of the chucking point and tidying up of the foot. This was achieved by reversing the bowl onto a previously turned dome and held in place by a live ring centre in the tail stock, turning away most of the tenon, snapping off and sanding away the remaining nib.



Rick's second demonstration was a simple square box, to be used as a vehicle to show the use of his home-made jig for multiple centre decorative turning. In the production of the box Rick gave us a number of interesting suggestions

- To ensure really crisp edges, particularly between the body and lid of a box, wrap masking tape around the area to be parted; this will prevent/reduce tear out.
- Having cut tenons in each end of the blank remount the block in the chuck at the lid end and work on that end first. This will help to ensure that the lid section remains true and aids the fit of top to bottom.
- When parting the top from the bottom section, turn the tenon that will fit into the lid, but then make the final parting cut just a millimetre from the base of the lid. This then leaves a small telltale showing the size that needs to be turned in the lid to accept the tenon on the body of the box.
- When hollowing the box, remember not to touch the outside of the tenon as it is already the correct size to fit into the lid.

Rick was then able to demonstrate a number of off-centre turned features using his homemade jig which allows him to quickly and easily change the turning axis and create many different patterns and features on any surface that can be held in the jig.

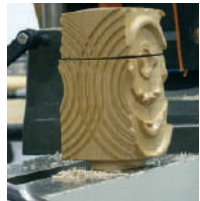
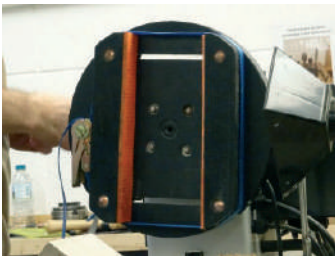





70 years of tooling excellence.

**PROOPS BROTHERS**  
ENGLAND • EST 1946 **.COM**

34 Saddington Road, Fleckney, Leicestershire, LE8 8AW

## Newark Show - March 2018

It was a great show with Ian doing a sterling job turning all day and many people showing a great deal of interest in the pieces made by club members. We had lots of them taking pictures of the items too, hopefully they have made versions for themselves from members' ideas!!

Hope this is of some use for you and your magazine

Cheers Lynne



*Save*  
US Stockist  
Enquiries Welcome.  
Tel/Fax 888-631-8311



# CHESTNUT

P A O D U C T S

*first for finishes*

*Lacquers*

*Polishes*

*Waxes*

*Polish Enhancers*

*Wood Treatments*

*Polishing Brushes*

*Abrasives*

*Stains*

*Thinners*

*Applicators*

*Superglues*

*Buffing Systems*

*Acrylic Blanks*

*...and much more*



Used by woodturners of all abilities throughout the UK and the world, the Chestnut Products range of top quality finishes gives outstanding results every time; whatever you are making and whatever your preferred finishing system there is bound to be something in our range to meet your needs.

*See your local stockist for more information  
or for a catalogue/price list contact us at:*

**Chestnut Products**

**PO Box 260, Stowmarket,  
IP14 9BX**

**Tel: 01473 890 118 Fax: 01473 206 522**

**[www.chestnutproducts.co.uk](http://www.chestnutproducts.co.uk)  
[mailroom@chestnutproducts.co.uk](mailto:mailroom@chestnutproducts.co.uk)**

*Stockist enquiries welcome*

## TRENT VALLEY TRADING

Lots of woodturning accessories are available to purchase at discounted prices from the shop. The list and price of equipment is available on request. Typical items include, clock inserts, polishes, super glue, wood etc

Also available is a range of clothing adorned with the TVWT club logo.

In addition to the above there is a library of books and DVDs which are available for hire at £1 per week. All proceeds going to the Club Funds.

## PHOTOGRAPHS

High definition photographs in this publication or on Club website are available for digital download free of charge.

Photographs are sent via email in JPEG format which can be processed at most high street shops with printing facilities i.e. Asda, Boots etc.

Anyone wanting photograph files should email [bill.percival@hotmail.co.uk](mailto:bill.percival@hotmail.co.uk)

### TVWT WEBSITE

The Club's Website address is  
<http://www.trentvalleywoodturners.co.uk>

Members are advised to look at the Website on a regular basis for any special or breaking news items.



/Trentvalleywoodturners

Visit our Facebook page at the above address

# charnwood

*Woodworking machinery at its best!*

Size 20mm x 20mm x 130mm Long.

Sand on the lathe using our PENSP foam backed sanding pads from 1500 up to 12000grit to give a super fine finish.

Finish with Burnishing Cream for a high gloss finish.

**Foam Backed  
Sanding Pads  
10cm x 8.5cm**

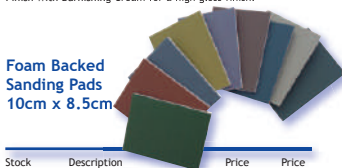

Stock Ref	Description	Price Ex VAT	Price Inc VAT
PENSP	Sanding Pad - Pack of 9	£8.33	£10.00

Designed specifically with pen turners in mind. This finishing kit consists of nine different, colour coded, foam backed sanding pads measuring 10cm (4") x 8.5cm (3.14").

Includes the following grit sizes:

1500 - Rust, 1800 - Green, 2400 - Black, 3200 - Tan,  
3600 - Wine/Brown, 4000 - Teal, 6000 - Purple,  
8000 - Royal Blue, 12000 - Grey

Suitable for wood and acrylic blanks.

## New Range of Pen Turning Items Including those below

**Classic Elite  
Rollerball &  
Fountain  
Pen**



Shown with AR24 Coffee with  
Pink Swirl Acrylic Blank

Shown with AR21 Coffee with  
Black Swirl Acrylic Blank

Stock ref	Description	Price Ex VAT	Price Inc VAT
PENERB	Classic Elite Rollerball Pen	£6.67	£8.00
PENEF	Classic Elite Fountain Pen	£6.67	£8.00
PENER	Black Rollerball Refill - Pack of 2	£2.08	£2.50
PENET	Spare Tubes - Upper & Lower	£2.08	£2.50
PENEBUSH	Bush Set	£2.50	£3.00
PBD10	10mm Drill Bit	£4.17	£5.00

This high quality gold plated Roller Ball pen makes the ideal gift along with the Fountain Pen.

Visit our website [www.charnwood.net](http://www.charnwood.net) or showroom at  
Cedar Court, Walker Road, Bardon Hill, Leicester, LE67 1TU  
Tel 01530 516926

## **Your Committee 2019**



**Chair**  
**Tony Stubbins**



**Vice-Chair**  
**Ian Ethell**



**Secretary**  
**Barbara Rundle**



**Treasurer**  
**David Routledge**



**Events Secretary**  
**Derek Henderson**



**Colin Oakhill**



**Brian Deakin**

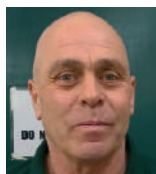

**Nick Winfield**



**Life President**  
**Vic Taft**

## **Communications**



**Webmaster**  
**Ben Wild**



**Woodward**  
**Editor**  
**Bill Percival**



TRENT VALLEY WOODTURNERS  
(Next to) Kegworth Village Hall  
Kegworth  
Leicestershire  
DE74 2FH



**The ToolPost**



LOTTERY FUNDED



/trentvalleywoodturners